

**WOLLATON AND LENTON ABBEY AREA COMMITTEE**  
**Food Growing Framework Update**  
**11 May 2010**

**9**

**Wards affected:** All  
**Director:** Hugh White, Director of Sports, Culture & Parks  
**Contact Officer:** Eddie Curry, Head of Parks & Open Spaces  
Tel: 9152784 email [Eddie.Curry@nottinghamcity.gov.uk](mailto:Eddie.Curry@nottinghamcity.gov.uk)

**Corporate Plan Themes:**

World Class Nottingham	
Work in Nottingham	
Safer Nottingham	
Neighbourhood Nottingham	×
Family Nottingham	
Healthy Nottingham	×
Serving Nottingham Better	

**What is this about?**

This report is a follow up to the Report to Wollaton and Lenton Abbey Committee 7<sup>th</sup> January 2010 which introduced the Nottingham Food Growing Framework.

The report gives an update on the progress of the Food Growing Framework and gives further detail about the provision of allotments in and around Wollaton and Lenton Abbey; it also proposes possible future directions for the individual parcels of land including Wollaton Park Walled Garden.

**Why is it being done?**

A report was presented to Wollaton and Lenton Abbey Area Committee on 7<sup>th</sup> January 2010 that introduced the Food Growing Framework. The Food Growing Framework has now been presented to all Area Committees and comments have been considered for the next draft.

At the meeting it was requested that a further report be submitted with an update on the process; and further details about the proposals for allotment gardens and community growing opportunities in the area.

**What are the issues or implications?**

**Update on the Food Growing Framework**

Feedback from consultation with the 9 Area Committees and wider public consultation is being used to develop the action plans for each of the Food Growing Framework work strand areas. We will be arranging meetings with Area Managers and/or Area Action Officers to discuss potential projects in their area that could act as pilot projects and be reflected in the delivery action plans.

**Allotment and Community Garden Provision Current Situation**

The maps attached (appendix A) to this briefing show the current range of allotments in Area 7. Each site has two rings or buffers marked around it:

- § A 1.25km distance buffer, which shows the catchment area of the site in terms of the distance people could be reasonably expected to travel.
- § A 'carrying capacity' buffer which relates the catchment area to the number of plots on the site. (Once an allotment plot is rented out, other people can't access it freely even if they live within 1.25km.)

Area 7 has a generally poor spread of allotment sites, although large parts of the Area are obviously made up of Wollaton Park and the University of Nottingham grounds. The greatest number of plots is on the Canal allotment site, but these are small and often used by people from the neighbouring houses. There is also small site known as 'Wollaton Park' close to Middleton Boulevard, and a number of small sites in Lenton Abbey.

There are some important and large sites just outside the boundary of Area 7 which provide allotments for Wollaton and Lenton Abbey, in particular the Old Park Farm allotments off Glaisdale Road and the Moorfield site off Ilkeston Road.

There is a large site of Allotment Gardens adjacent to Russell Drive and Martin's Pond Local Nature Reserve. The site consists of 90 plots owned as individual freehold plots and managed by a committee. Approximately just under 50% of the site is unused and was taken out of the Open Space Network in the Nottingham Local Plan by the High Court in Sept 2006. As none of the site is owned by Nottingham City Council, it is vulnerable to pressure of built development. The site is protected by current development control policies, but the tenure of the land means that it does not serve the local community as affectively as a site under the control of the City Council. The unused land is not currently serving the community as allotments and it may have more value to biodiversity and wildlife as a buffer to the Local Nature Reserves than as allotment gardens. Fortunately in terms of provision, there is good access to Canal and Old Park Farm sites.

### **Recommendations for future allotment and community garden provision**

The Allotment Service recommends that the larger sites in the Area should be retained (along with those just outside the Area). However, the plots in Lenton Abbey are currently underused and many have been vacant for some years. Although they have been offered to prospective tenants, there has been little take up. The Lenton Abbey plots are typical of a number of sites across Nottingham, which were laid out in the mid twentieth century in the middle of housing estates (usually built as council housing). Access to the plots is usually down a small alley between houses, the plots are small and they have no water supply. Access is often made worse if the houses or land has been sold – in some cases the allotments are effectively 'landlocked'. The Wollaton Park site is only accessible via one alley way between houses, and although currently in use has been vacant for long periods in the past.

The Allotment Service believes that these smaller sites are generally not viable as allotments in the long term. They are unpopular, difficult to maintain, and provide little effective provision for residents in the Area as a whole. As an alternative these sites could be:

- § Converted to wildlife areas
- § Sold to neighbouring housing as garden extensions (this has already happened in some cases)
- § Have a change of use to allow housing or other development

§ Be used by community groups for food growing, as an orchard or community space.

NB Some plots are currently in use as allotments – the Allotment Service would not look to change their status unless the plot holder was in agreement or until the plot became vacant.

The table in Appendix B gives a description and context of each of the parcels of land in the Wollaton and Lenton Abbey area along with possible options for future uses.

### **What you need to the Committee to do**

- § The Area Committee consider the food growing needs and opportunities in their area and provide information relating to this to help inform the strategy's action planning.
- § That Committee respond to the proposals for allotment and community garden provision in their Area:
  - A. Proposal to retain allotments as shown on the maps
  - B. Proposal to change the use of potentially non-viable allotments sites as shown on map

### **What the service will do as a result**

Information provided by the Area Committee will help inform action plans currently being developed for each of the work strands.

Recommendations for allotment and community garden sites which have emerged through the provision standard methodology are put forward to help determine the best use for these sites and to help channel resources where provision is lacking and need is identified.

A list of preferred options will be taken forward for further consultation with relevant stakeholders.

### **Timetable**

Preferred options list produced May 2010

Discussions with Neighbourhood Management May /June 2010

Final Food Growing Framework document summer 2010

### **Want to find out more?**

**Website:** [www.nottinghamcity.gov.uk/parks](http://www.nottinghamcity.gov.uk/parks)

**Phone:** Paul Owen 9152727

**E-mail:** [paul.owen@nottinghamcity.gov.uk](mailto:paul.owen@nottinghamcity.gov.uk)

**Write:** Paul Owen

**Allotment and Community Gardens Officer**

**Parks and Open Space**

**Nottingham City Council**

**Woodthorpe Grange**

**Woodthorpe Drive**

**Nottingham NG5 4HA**

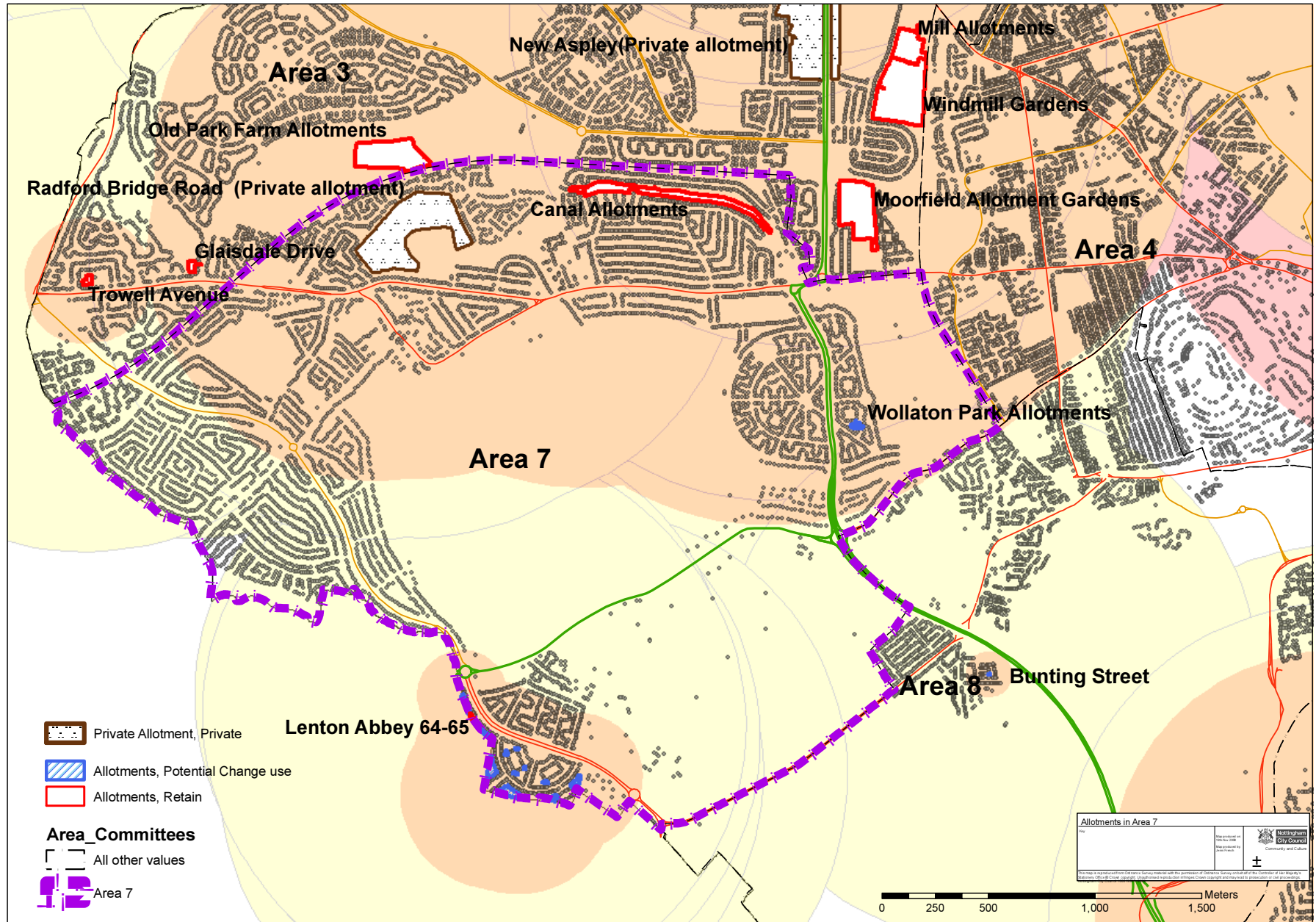

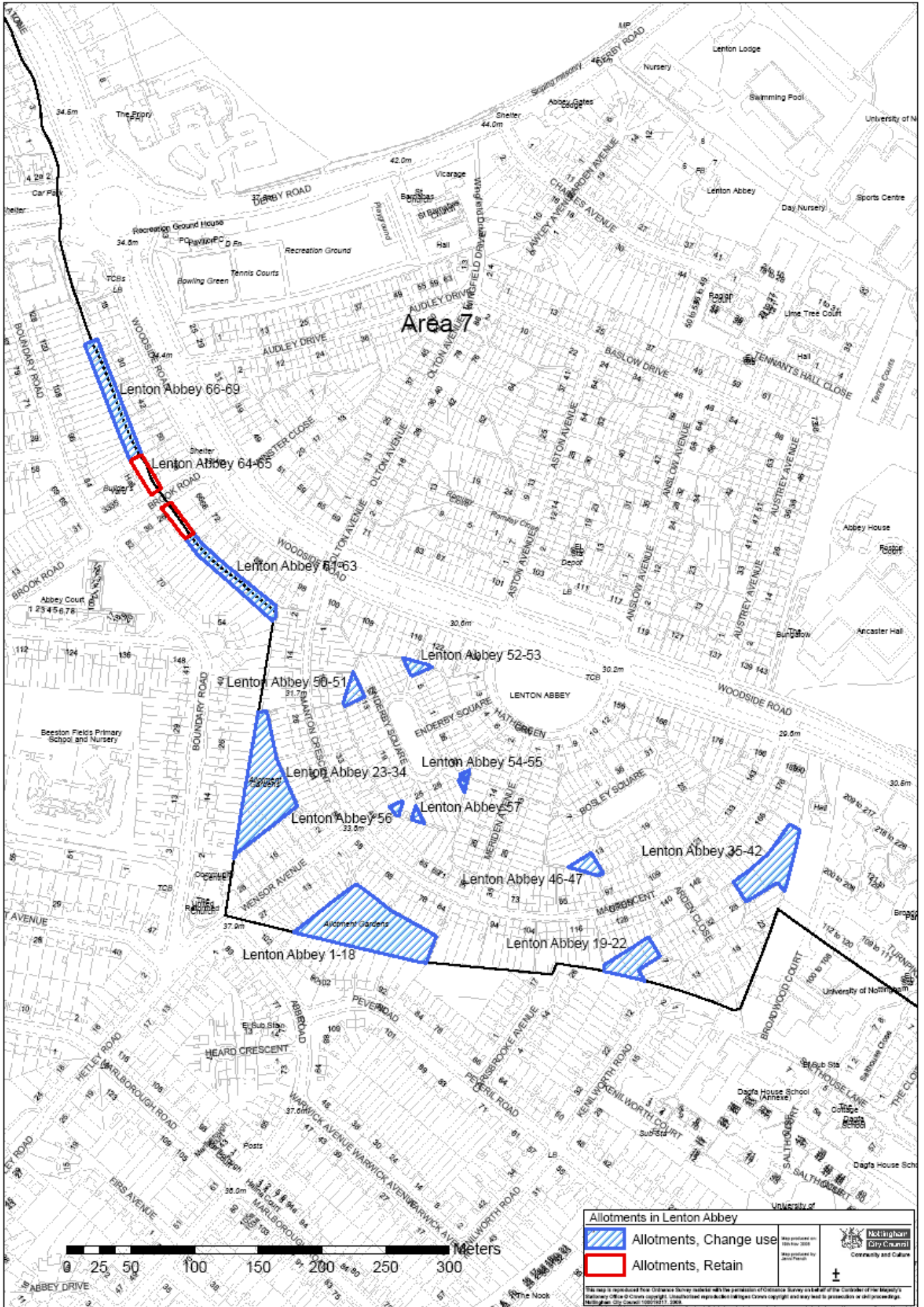

Allotments in Lenton Abbey		 Nottingham City Council Community and Culture
	Allotments, Change use	
	Allotments, Retain	

This map is reproduced from Ordnance Survey data with the permission of Ordnance Survey on behalf of the Controller of the Majesty's Stationery Office. Crown Copyright. Unauthorised reproduction is prohibited. Ordnance Survey is a registered trademark of Ordnance Survey Limited. All rights reserved. 2008.

Appendix b

NAME	Area_sq m	Current Situation	Future Proposal
Lenton Abbey 1-18	3347.9	Combination of cultivated plots and new community garden site	Continue to use as community garden Pursue license to occupy As plots become vacant possibility of increasing size of community garden.
Lenton Abbey 19-22	719.2	4 small plots only one let others overgrown and shaded, not secure	Discuss handing land back to Strategic Housing - Possibility of garden extensions or regeneration
Lenton Abbey 23-34	2537.1	Overgrown and inaccessible some localised fly tipping	Possibility of community nature reserve or orchard but no funding for this
Lenton Abbey 35-42	1308.1	All plots let and cultivated poor access	Short term continue to let Investigate access via university owned land if more than 50% becomes vacant investigate sale to residents or university
Lenton Abbey 46-47	231.1	Vacant appears to be used by residents poor access, very small not secure	Sale to residents or managed by Housing Office as amenity space,
Lenton Abbey 50-51	213.2	Vacant, poor access, trees on site, not secure	Sale to residents or managed by Housing Office as amenity space,
Lenton Abbey 52-53	150.9	Let, no access believed used as garden extension would be difficult to re-let	Offer for sale to resident
Lenton Abbey 54-55	61.5	Very small plots not recognisable as allotments believed used by residents	Sale to residents or managed by Housing Office as amenity space,
Lenton Abbey 56	64.4	Very small plots not recognisable as allotments over grown	Possibility of car parking spaces
Lenton Abbey 57	60.1	Very small plots not recognisable as allotments over grown	Possibility of car parking spaces
Lenton Abbey 61-63	1089.0	Currently let to individuals- Access very difficult - size very narrow	Long term consider sale to residents

Lenton Abbey 64	1089.0	Secure Plot Currently let Good Access from road	Retain as allotment plot
Lenton Abbey 66-69	1357.6	Currently new community project let as allotment plots	Investigate change of agreement to license to occupy
Wollaton Park	999.4	Currently all let Access is poor	Short term remain as allotments long term may be better as community garden or sold to residents.
Canal Allotments	28795.4	Narrow strip of allotments that are on top of old canal, Access reasonable. Some plots sold as garden extensions in the 1990s	Retain all remaining plots owned by Nottingham City Council as allotment garden plots and ensure cultivation
Radford Bridge Road Private Allotments	99011.8	Private site, underused. City Council include the site in information that is sent out to the public but does not have a direct line of communication with the site managers.	In the short term the Allotment Service propose to improve communication with the site to investigate opportunities to let more plots .  In the long term the future development of the site may be affected by proposals and applications from developers.
Wollaton Park Walled Garden	500	Has been suggested as a possible site for a community food growing space. It is currently under the control of Culture and is occupied by the Hardy Plant Society. Although it is a central location the walled garden is 800m from the nearest resident.	Parks and Open Spaces will consult with the Hardy Plant Society and colleagues in Culture to clarify to tenure of this site and any possible partnership opportunities.